



MOSSY OAK PROPERTIES

938 Acres Hardwood and Pine Timber Near Ripley

\$1 / 938.47+/- Acres

About This Property

Bordering Little Hatchie River in Tippah County, this nice tract of hardwood and pine is a fantastic investment. Nearly half a mile along the Little Hatchie River provide plenty of water for the wildlife and a few ducks! Good system of trails. The timber has several different age classes and types, making for a good cash flow. Excellent access is available from CR 540 and CR 536. Neeley Branch meanders through the property. Convenient to Ripley, Mississippi. Please call for current pricing.



Summary

- 613.30 acres of Loblolly pine (various ages)
- 301.52 acres of hardwood
- Remaining acreage in roads, fields, and utility right-of-ways

For more information or to schedule an appointment to view the property, call Nathan McCollum at (256) 345-0074 or email nmccollum@mossyoakproperties.com. We also have other tracts that are not yet on-line that might fit what you are looking for. Give us a call and we'll help you find something that meets your needs!

Property Facts & Features

Main Structure

- No Structure

Other Structures

- N/A

Rights

- N/A

Water Access

- Pond

Fishing

- N/A

Wildlife

- Small Game
- Turkey
- Whitetail

Recreation

- N/A



Mossy Oak Properties Southeast Land & Wildlife, LLC

1229 Hwy 72 East
Tuscumbia, AL 35674

Phone: (256) 383-8901

Fax: (256) 383-8902

Link: <http://www.mossyoakproperties.com/land/40150>



MOSSY OAK PROPERTIES



**Mossy Oak Properties Southeast
Land & Wildlife, LLC**

1229 Hwy 72 East
Tuscumbia, AL 35674

Phone: (256) 383-8901

Fax: (256) 383-8902

Link: <http://www.mossyoakproperties.com/land/40150>



MOSSY OAK PROPERTIES

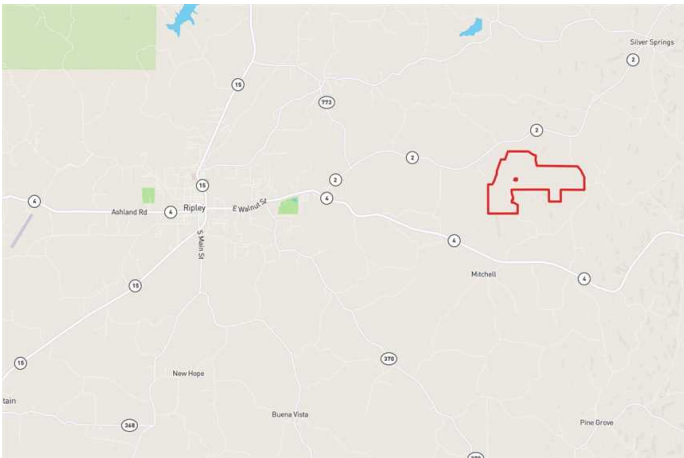
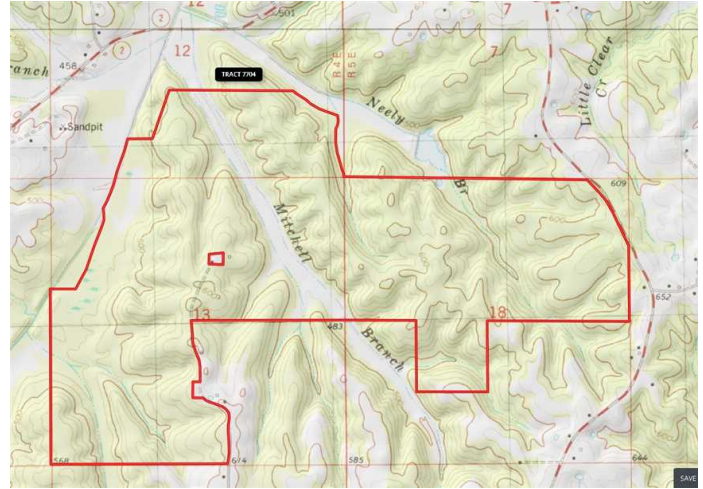

Mossy Oak Properties Southeast Land & Wildlife, LLC

1229 Hwy 72 East
Tuscumbia, AL 35674

Phone: (256) 383-8901

Fax: (256) 383-8902

Link: <http://www.mossyoakproperties.com/land/40150>